

# Liberty

## Hinge Door & Side Panel

### KLC + KR / TLC + TR

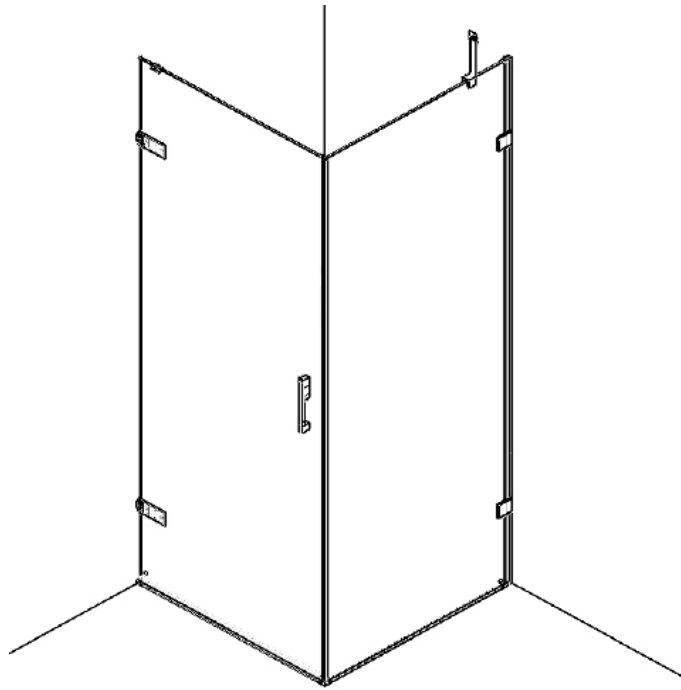

#### Handling

Be aware toughened glass can shatter if not handled correctly. It should not be subjected to any sharp impact and it is essential to protect the glass by resting it on a soft protective surface during installation such as cardboard or carpeting. It is recommended to wear PPE at all times during installation.



#### Pre-Installation Checks

1. Please take time to read these instructions prior to installing your product, including the Tray Sizes section below.
2. Check you have the correct product, by looking at the labels on the side of the product packaging.
3. Check all the product components and fixing kits are in the box - [these are listed on the next page](#).
4. Please check the product for defects or damage, once the installation has commenced we cannot accept responsibility for any defects or damage.
5. Before you commence any drilling check there are no hidden electrical cables and/or water pipes.
6. No attempt should be made to re-work the toughened safety glass.
7. The installation of the product should be performed by two persons.
8. It is strongly recommended the product is fitted on a tiled surface or similar waterproof surface - which are tiled and grouted before product is installed.
9. It is strongly recommended that the walls the product is going to be installed on are vertical, and the floor/tray is level.
10. Please note that some natural misting may occur when you remove this product from its packaging, due to the addition of the glass protection pre-coating. If this does occur this can easily be removed with a soft, dry cloth.

#### Tray Sizes

Important: You MUST measure your tray before you proceed with installation. Liberty Corner Products have been designed to fit on standard Roman trays which have only been tiled over by 10mm at a maximum, If your tray exceeds this given value, you may need a bespoke product. The 'Adjustment' displayed in the brochure or on your bespoke customer drawing is not the required tray size - your tray must be at least 10mm larger than the MID Adjustment of the product.

Refer to Step 1 for a guide on how to measure your tray accurately before proceeding any further - Roman will not be liable if you begin installation without correctly measuring your tray, to the realisation it doesn't fit.

#### Consumer Guarantee

Please make sure the purchaser/end user completes and returns the guarantee card which is enclosed with this product. Failure to validate the Guarantee will mean only the 1 Year Statutory Guarantee will apply.



### Equipment Checklist: Not Supplied

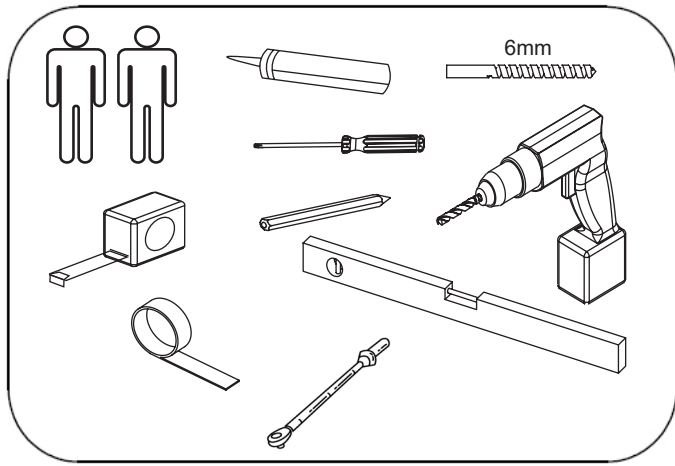

### Fixing Kit Components

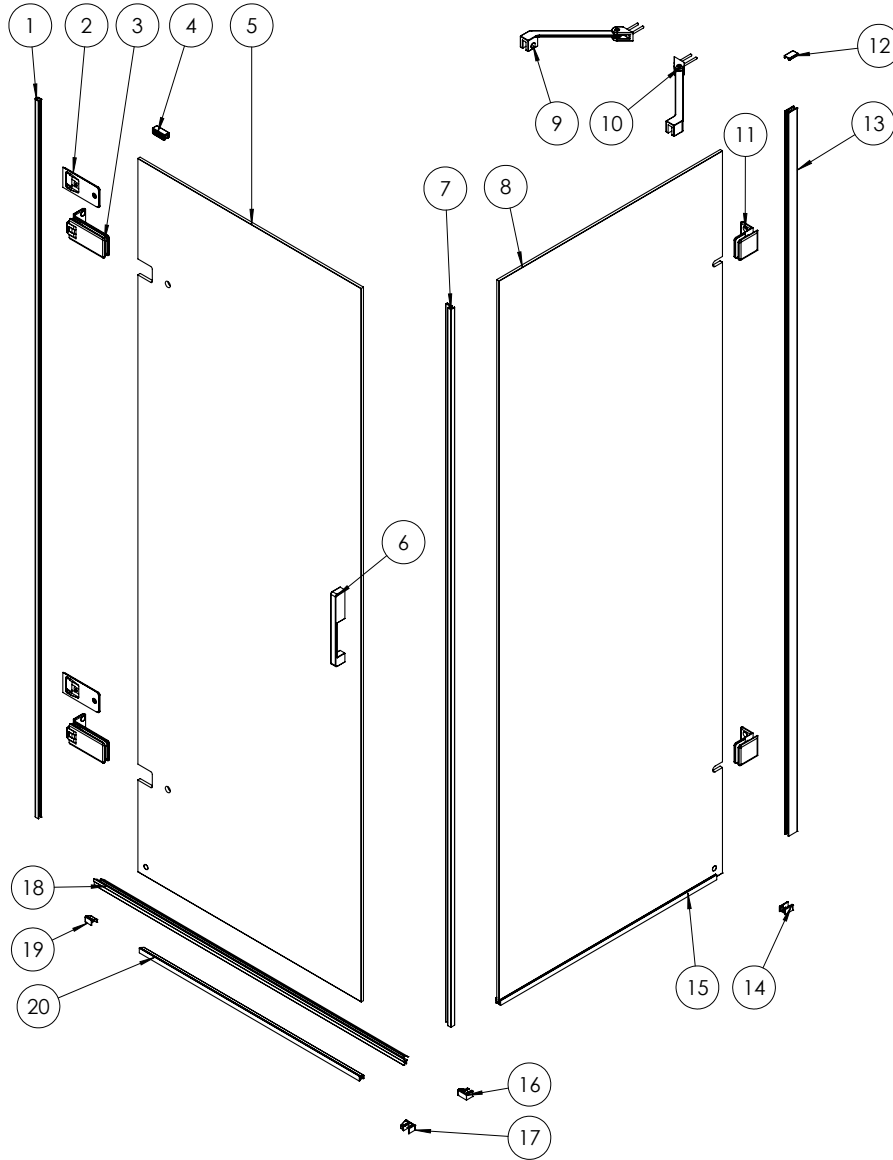
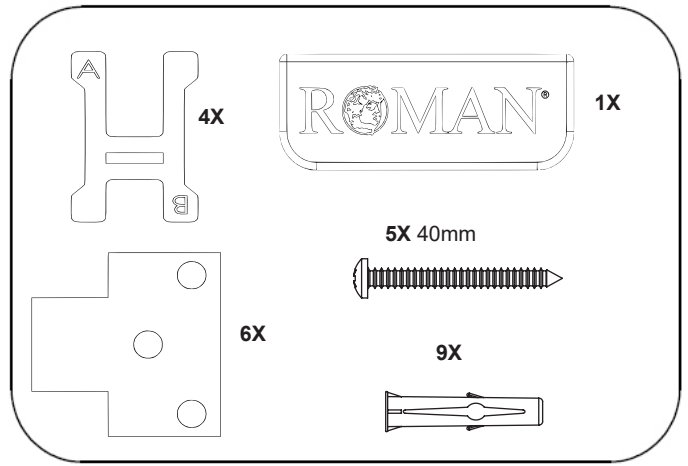

No.	Description	Qty.	No.	Description	Qty.
1	Bubble Seal	1	11	Wall Brackets	2
2	Backplate & Gasket	2	12	Top Cap	1
3	Glass to Wall Hinge Assemblies	2	13	Wall Profile	1
4	Branding Badge	1	14	Dam to Profile Joint	1
5	Door Glass	1	15	Bottom Rail	1
6	Door Handle	1	16	Bottom Corner Joint (R-H)	1
7	Vertical Panel Seal	1	17	Bottom Corner Joint (L-H)	1
8	Panel Glass	1	18	Door Bottom Seal	1
9	Bracing Assembly (L-Hand)	1	19	Dam to Wall Joint	1
10	Bracing Assembly (R-Hand)	1	20	Door Bottom Rail	1

## Step 1 - Tray Sizes

Your area must be tiled and grouted before measuring your tray - refer to your tray installation instructions and ensure this is done correctly. This is because tray measurements are taken from the tiled wall. Once tray installation is complete you can proceed to measuring the area. Liberty Corner Products have been designed to fit on trays which have been tiled over by 10mm **maximum** (product will still fit if it has been tiled less than this). The tables below show the range of tray widths which will allow for correct fitment - this is for standard products only. For Bespoke products please refer to your customer drawing for the MID Adjustment of the Door / Side Panel, and add 10mm for your required/minimum tray width.

Door Code	Tray Width
KL7613C / TL7613C	750mm - 760mm
KL813C / TL813C	790mm - 800mm
KL913C / TL913C	890mm - 900mm
KL1013C / TL1013C	990mm - 1000mm

Side Panel Code	Tray Width
KR7613 / TR7613	750mm - 760mm
KR813 / TR813	790mm - 800mm
KR913 / TR913	890mm - 900mm
KR1013 / TR1013	990mm - 1000mm

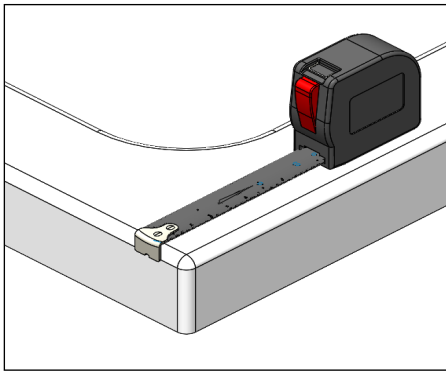

Measure from the very outside of the tray - before the radius. Go all the way to the tiled wall.

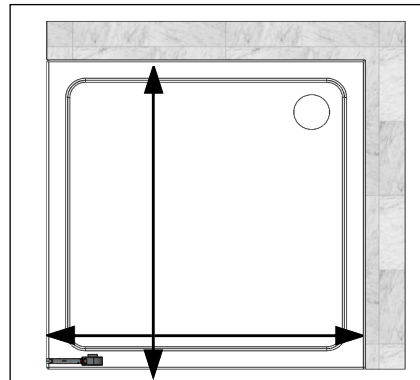

Decide which side the Door will go, and which side the Side Panel will go. Use the table above and measure both sides of the tray.

If your tray exceeds the given amount for your product size, you may need a bespoke product.

## Step 2 - Pre-Installation Checks

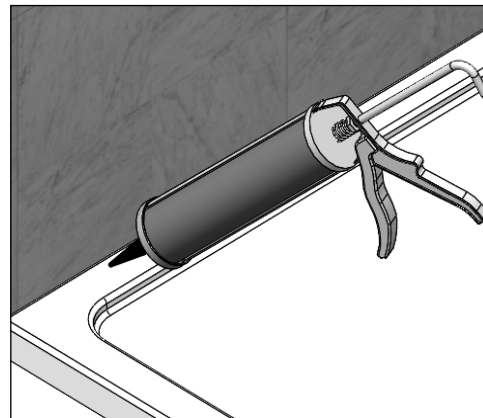
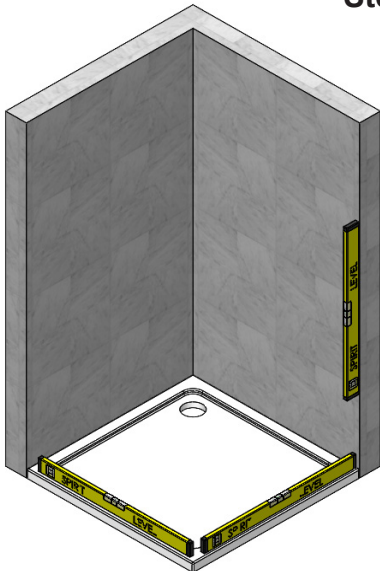

1. Make sure the tray is installed as per the manufacturer's instructions.
2. Check your Tray and Walls are level on all sides (the bubble on the spirit level must be in the centre of the 2 lines).
  - If the Walls & Tray are not level you will not achieve the +/- 7mm of adjustment.
3. Stand in the tray and check that there is no adverse movement (correct if necessary).
4. The walls should be tiled and grouted up to the tray.
5. The tiles and the tray should be sealed using a good quality bathroom sealant:
  - Spray the seal and joints with the shower head and check for leaks when the silicon has cured.
  - Check the plumbing for leaks.
  - DO NOT plasterboard over the tray.
  - DO NOT grout the tiles when the enclosure has been fitted, the grout may discolour the aluminium profiles.

### Step 3 - Side Panel Wall Profile

**IMPORTANT:** The table below is for standard products only. If you have purchased a bespoke product, measure the width of the Door Glass, and for an 8mm product, add 7mm for Dimension 'Y' and for 10mm, add 6mm.

1. Decide which side your Side Panel will be sat on, find your correct 'Y' distance using the table below/text above (this suits your door size) and measure from the opposite wall using a tape measure, and mark the wall using a pencil.
2. Place a Spirit Level onto the pencil mark and add a pencil line fully up the wall.
  - **Placing some masking tape where the Wall Profile will go will help with marking out and protect the tiles when drilling.**
  - **Use the Spirit Level and ensure the pencil line is completely vertical.**
3. Place the inside of the Wall Profile onto the pencil line making sure that it is fully vertical.
4. Mark the Wall through the holes in the Wall Profile.
5. Remove the Profile, and drill with a 6mm masonry drill (not supplied). Then proceed to remove the masking tape and fit the Wall Plugs.
  - **Remove any debris.**
6. Apply a bead of sealant the width of the Panel Profile where it meets the top of the tray and the tiled wall.
7. Place the Wall Fixing screws into the holes in the Panel Profile, lining them up with the holes in the Wall and tighten all screws.

To suit Door	Dimension 'Y'
KL7613C	727
TL7613C	726
KL813C	767
TL813C	766
KL913C	867
TL913C	866
KL1013C	967
TL1013C	966

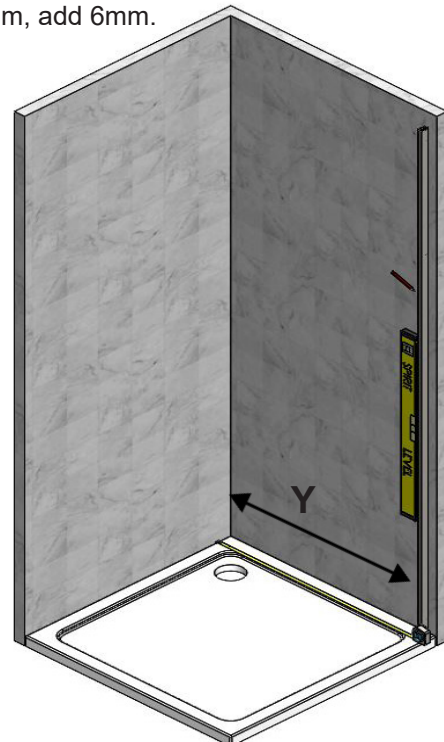
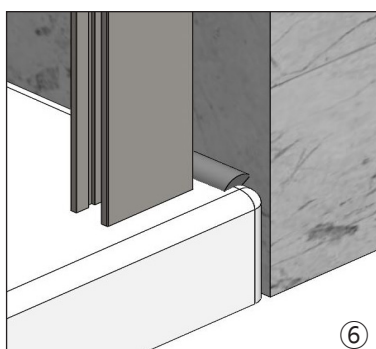

### Step 4 - Panel Wall Bracket Positions

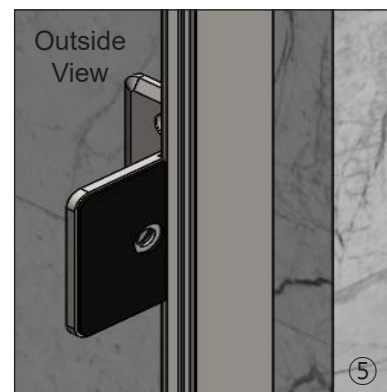
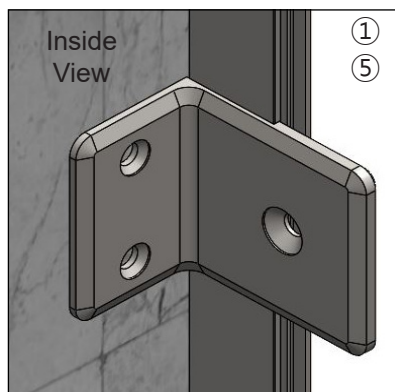
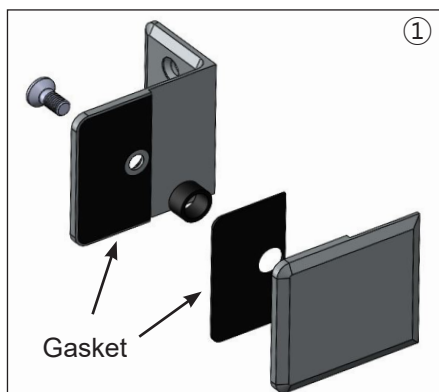

1. Dismantle the Wall Brackets and fit onto the Panel Glass ensuring that all gaskets are fitted. Ensure that the brackets are fitted the correct way (screws to the inside).
  - **IMPORTANT: If you have purchased a product with a print, please ensure you fit the print on the outside.**
2. Carefully lift the Panel into the Panel Wall Profile and up to the wall.
3. Mark the wall through the holes in the Brackets using a pencil. Remove the Panel.
4. Drill the wall with a 6mm masonry drill (not supplied). Fit the Wall Plugs and remove any debris.
5. Remove the brackets from the Panel and fasten the inside bracket to the wall and over the Wall Profile.



## Step 5 - Door Hinge Position

**IMPORTANT:** The table below is for standard products only. If you have purchased a bespoke product, measure the width of the Side Panel Glass, and reduce it by 31mm mm for Dimension 'X'.

- For the Door, find your correct 'X' distance using the table below/text above, and measure from the opposite Wall using a tape measure, and mark the wall using a pencil.
- Place a Spirit Level onto the pencil mark and add a pencil line fully up the wall.
  - Placing some masking tape where the Wall Profile will go will help with marking out and protect the tiles when drilling.
  - Use the Spirit Level and ensure the pencil line is completely vertical.
- Make sure you have the Door Glass the correct way then carefully dismantle the Door Hinge Assemblies and fit to the glass ensuring all gaskets are fitted.
  - IMPORTANT:** If you have purchased an 8mm product use **TWO** gaskets either side of the glass (one thick and one thin), if you have purchased a 10mm product use **ONE** thicker gasket either side of the glass.
  - IMPORTANT:** If you have purchased a product with a print, please ensure you fit the print on the outside.
- Take the Red Door Setting Blocks and slide them together to create 2 small assemblies. Position them on the tray where the Door is going to go.
- Lift the Door assembly onto the Red Setting Blocks and up to the wall.
- Line the inside of the Hinge Bracket onto the pencil line ensuring it is kept completely vertical.
- Mark the wall through the holes in the Hinge Bracket.
- Remove the Door Assembly then drill the wall with a 6mm masonry drill (not supplied). Remove the Masking Tape and fit the Wall Plugs and remove any debris.
- Carefully remove the Hinge Assemblies from the Door Glass.
  - IMPORTANT:** We recommend that 2 people do the operations as shown above.

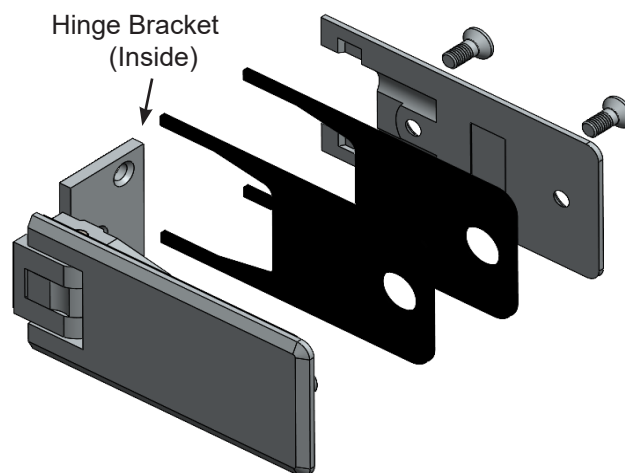
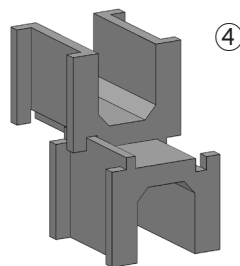
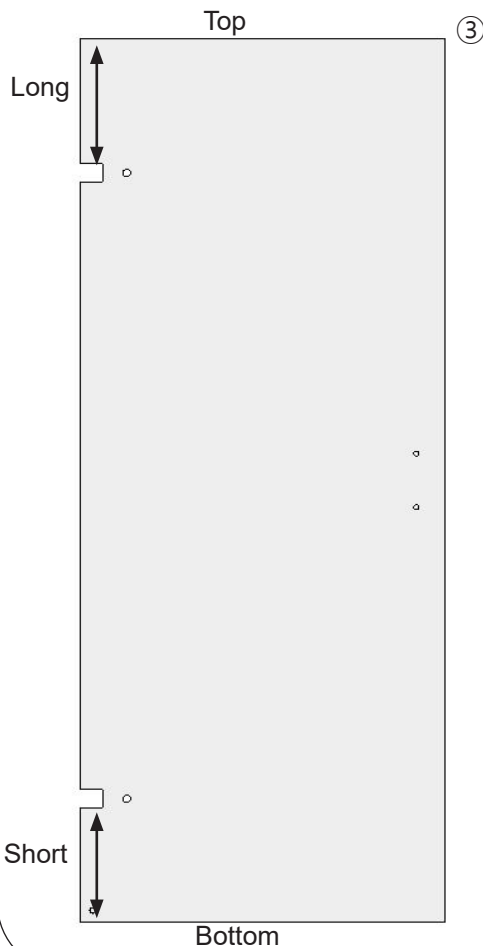
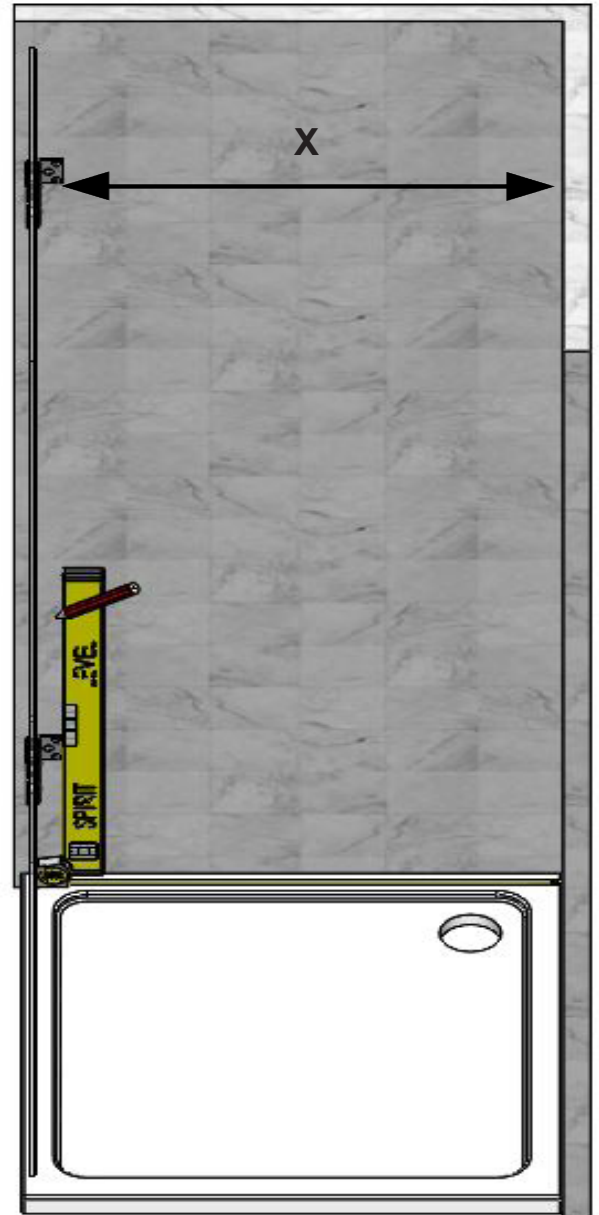

To Suit Panel	Dimension 'X'
KR7613 / TR7613	689
KR813 / TR813	729
KR913 / TR913	829
KR1013 / TR913	929

## Step 6 - Fitting the Door

Note: This Product comes supplied with a different Backplate (x2) which is to help with Water Integrity - these are optional however strongly recommended especially if the Drencher is located in a position where Water will be aimed towards the Hinges. This Backplate will make the Door Outward Opening Only. If you decide not to fit these at this point, still keep them as they can be used in the future if required.

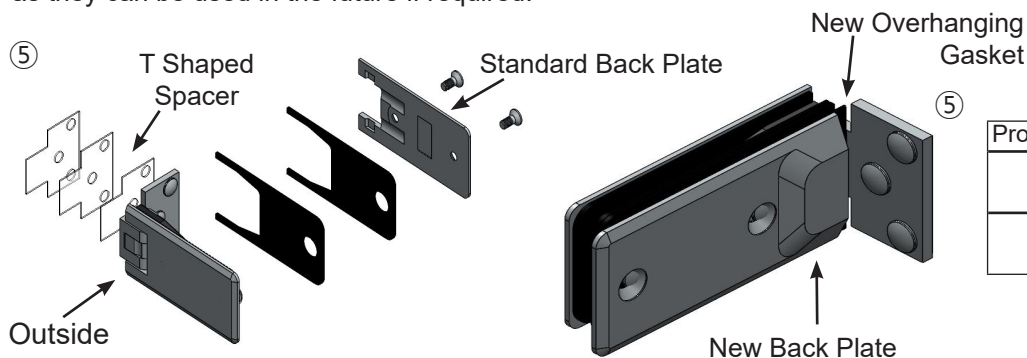

Product Thickness	Gaskets Required
8mm	2 Gaskets either side of the Glass
10mm	1 Thinner Gasket either side of the Glass

1. Fasten the Hinges to the Wall using the countersink screws supplied.
2. Remove the screws from the back of the hinges, then remove the backplate and ensure there is the correct amount of gaskets on each hinge (See Table)
  - **Note: With the replacement back plate fitted, the product is outward opening only.**
3. Take the Door Setting Blocks and slide them together to create 2 small assemblies. Position them on the tray where the Door is going to go.
4. With the Door Glass the correct way round offer it onto the Hinges and onto the Red Setting Blocks
  - **IMPORTANT: If you have purchased a product with a print, please ensure you fit the print on the outside.**
5. If you are using the new Backplate, you must replace the back plate (as shown above) and swap out 1 gasket from the hinge with new over hanging gasket onto the Hinges and fully tighten the countersink screws. If you arent, fit the standard Backplate with enough Gaskets as shown.
  - **IMPORTANT: Tighten the 4 Hinge fixing screws to 10N/m using a torque wrench.**
  - **Note: Included with the Product are 6 'T' Shaped Spaces. These are intended to help with out of true Walls.**
6. Remove the Handle Assembly from it's packaging and reassemble onto the Door Glass, ensure that the set screws are fitted on the inside of the Door and all gaskets are used between the glass and metal parts.

## Step 7 - Fitting the Side Panel

**IMPORTANT:** The dimensions are from the tiled wall.

1. Place the Dam to Profile Joint over the Panel Profile at the bottom and push to the wall.
2. Place the Panel Assembly into the Panel Profile. The outer edge of the glass should be set to the required dimension "A" (see table) from the back wall when it is level.
  - **IMPORTANT: If you have purchased a product with a print, please ensure you fit the print on the outside.**
  - **Dimension 'A' is for standard products only - if you have purchased a bespoke product measure the width of the Glass and add 36mm.**
3. Attach the front of the Wall Brackets to the already fitted Brackets and tighten, ensure that the gaskets are placed between the Brackets and glass.
4. Ensure that the glass is completely vertical using a Spirit Level and has not moved from Dimension "A" then fully tighten the Wall Brackets.

To Suit Panel	Dimension 'X'
KR7613 / TR7613	738
KR813 / TR813	778
KR913 / TR913	878
KR1013 / TR913	978

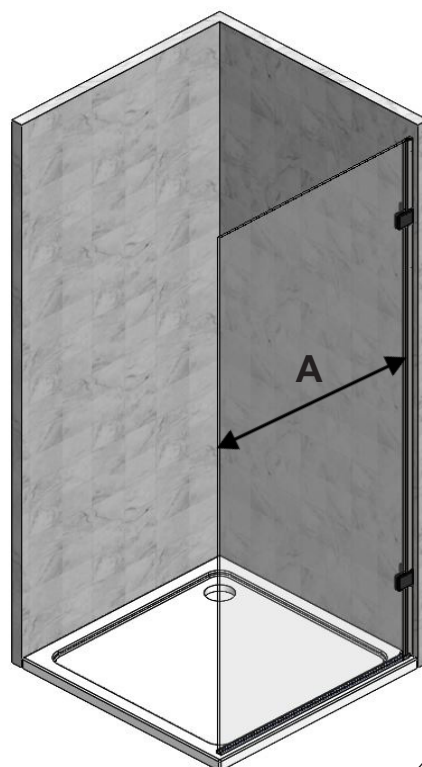
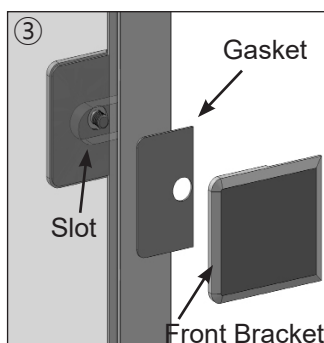
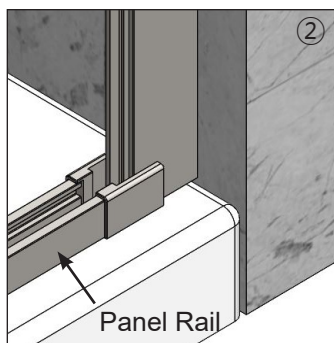
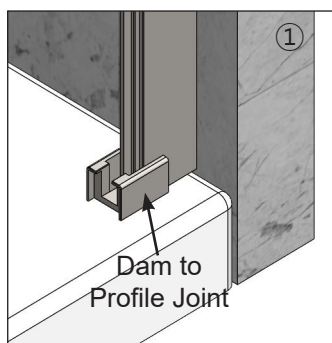

## Step 7 - Fitting the Side Panel Continued

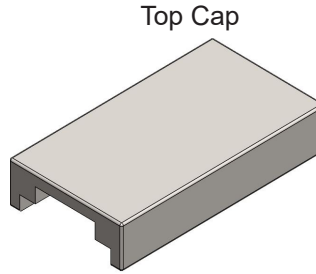
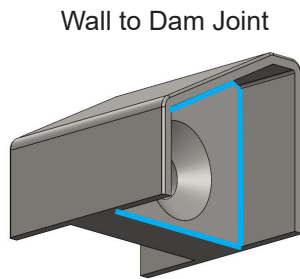
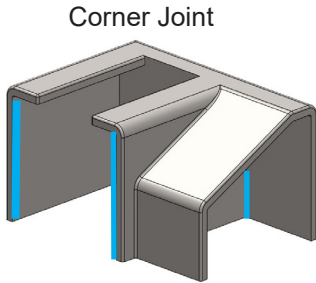
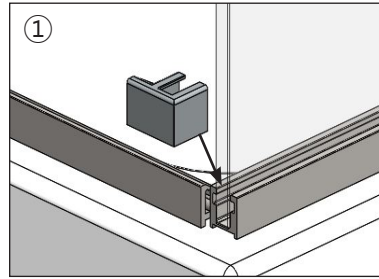
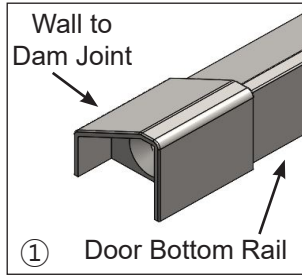

1. Place the Wall to Dam Joint over the Door Bottom Rail on the Door side and fit the Corner Joint at the Panel side. Ensure that the Wall to Dam Joint butts up to the tiled wall and the Corner Joint fits over the Panel Aluminium (if required slide the rail along to achieve this). Check the Panel and Door Bottom Rail are parallel to the tray and the slope faces inward towards the shower.
2. Apply a small bead of silicon the underside of the Bottom Rail Corner Joint (select the correct handing) where the bottom rails go (both sides) and fit over both sets of bottom rails at the corner - see image of highlighted areas.
3. Lift the Wall to Dam Joint and place a bead of silicon to the base, add a bead of silicon the inside of the Wall to Dam Joint at the side that goes over the rails and refit.
4. Check the Panel and the Door Bottom Rails are still parallel to the outside of the tray making sure that the Bottom Rail Corner Joint is fitted correctly over the rails (move the Panel if required).
5. Fit the Top Cap to the top of the Side Panel Profile.
6. Fit the Roman Branding Clip to the top of the Door Glass using a small amount of silicon to hold in place.

## Step 8 - Fitting the Seals



1. The Bottom Seal requires a rebate at one end only (Handle side). Fit the Bottom Seal so that the rebated end is level with the glass at the Handle side of the door and cut it to length so that it butts up to the Hinge Vertical Extrusion when the Door is closed. Push fully onto the glass.
  - **NOTE: With the Door closed measure from the Hinge Vertical Extrusion to the end of the glass.**
2. Fit the Bubble Seals to the Hinge Side of the Door Glass, trim as required.
  - **NOTE: The lower seal should sit as close to the top of the Wall to Dam Joint as possible.**
3. Select the correct hand of the Side Panel Seal and fit onto the end of the Panel. Ensure the rebate sits on top of the Corner Joint and the flippers go down on the inside.

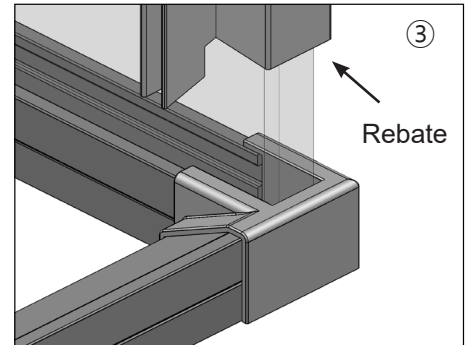
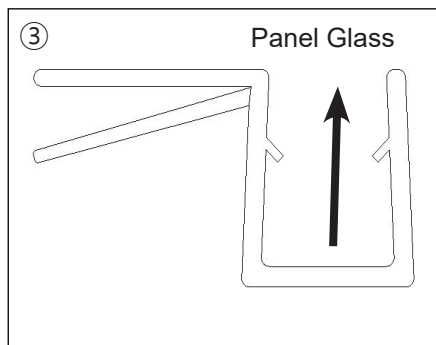
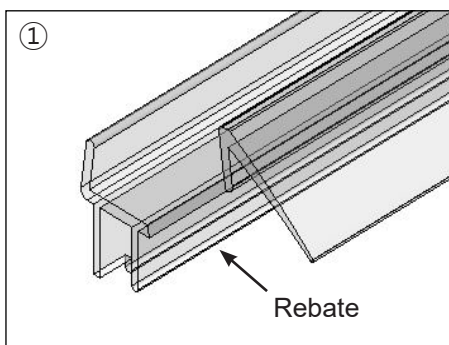

## Step 9 - Bracing and Sealing

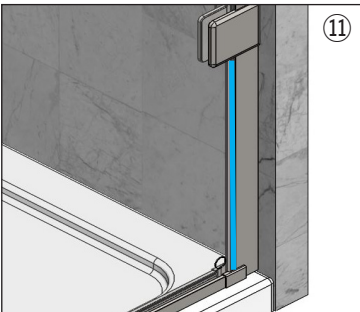
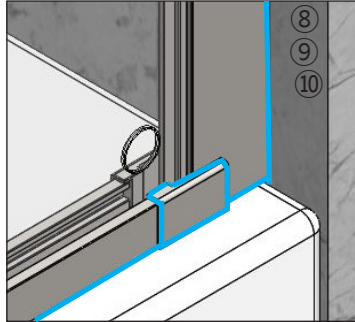
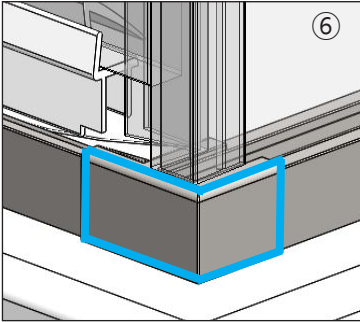
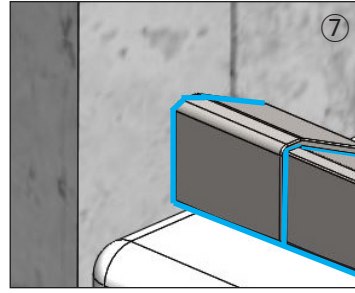
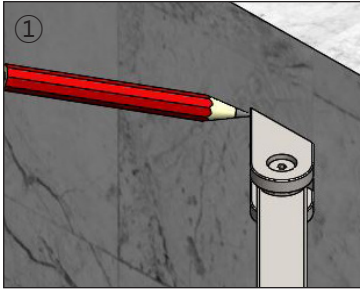

1. Place the correct handing Bracing onto the Panel Glass and up to the tiled Wall, and using a spirit level to ensure its level, mark the tiles around the Wall Bracket. Then remove the bracing and remove the Wall Bracket from the assembly, and place it over the pencil mark. Mark the hole positions.
  - **NOTE: Place masking tape where the Wall Bracket is to go as it will protect the tiles and aid in marking.**
2. Drill the hole positions using a 6mm drill bit and fit the Wall Plugs.
3. Fit the Wall Bracket to the tiled wall using the screws supplied.
4. Place the Bracing onto the top of the Panel Glass and into the Wall Bracket and re-assemble.
5. Ensure that the gaskets are between the Glass and Bracing then fully tighten all screws in the Bracing.
6. Place a bead of silicon around the top of the Corner Joint and up the sides.
7. Place a bead of silicon around the top of the Wall to Dam Joint, up the sides and to the wall.
8. Place a bead of silicon around the top of the Dam to Profile Joint and up the sides.
9. Seal the base of the enclosure horizontally on the outside only where it meets the tray.
10. Seal the Side Panel Wall Profile up from the tray on the inside and outside.
11. Seal up from the top of the Dam to Profile joint where the Glass meets the Wall Profile up to the first Bracket on the outside only
  - **Do not seal along the base on the inside, failure to comply may result in leakage.**
  - **Please allow 24 hours for the sealant to fully cure before using the enclosure.**
  - **IMPORTANT: Failure to follow the above may result in serious water damage and will not be covered under the terms of the guarantee.**

# Trouble Shooting Guide

Should you experience any problems during installation please refer to the Trouble Shooting Guide or contact Customer Relations on:  
+44 (0) 1325 328033

To enable customer relations to provide you with an excellent level of service it is important that you quote your product Code and Reference Number - these can be found on the Guarantee card.

Problem	Solution
Leaking	<ol style="list-style-type: none"><li>1. Check that the inside gap between the Tray and Wall profile has been sealed correctly.</li><li>2. Ensure the tray is sealed along the tiled walls prior to installation.</li><li>3. If the inside joint between the enclosure and the tray top is sealed, this will cause leakage - sealant must be removed.</li><li>4. Ensure the joint between the enclosure and tray top is sealed on the outside.</li><li>5. Ensure that there are no gaps between the Panels at the corner.</li></ol> <p>Important: This enclosure should be water tested conforming to BS EN 14428</p>
Enclosure Alignment on Tray	<ol style="list-style-type: none"><li>1. Have you read and understood Step 1 of the instructions?</li><li>2. Is the enclosure fitted onto a tiled wall?</li><li>3. Is the wall profile completely vertical?</li></ol>
Door not operating correctly	<ol style="list-style-type: none"><li>1. Ensure both Hinge Assemblies are completely vertical.</li><li>2. Adjusting the Set screw on the inside of the Hinges can help.</li><li>3. Ensure the tray is completely level.</li><li>4. Check the bottom of the door is parallel to the top of the tray.</li></ol>
Door Alignment	<ol style="list-style-type: none"><li>1. Ensure the Hinge Assemblies are completely vertical.</li><li>2. Ensure you have read and understood Step 1 of the instructions.</li><li>3. Check the bottom of the Door is parallel to the top of the Tray.</li><li>4. Check the Hinge Screws have been fully tightened to 10N/m.</li></ol>
Panel Alignment	<ol style="list-style-type: none"><li>1. Ensure the Tray is completely level.</li><li>2. Check the Bracing is fitted correctly and fully tightened.</li></ol>

## Important Information to help you maintain your Product:

The following information is all you need to keep your product looking new.

Our products are generally maintenance free, however it may be necessary to lubricate wheel assemblies and other moving parts such as hinges from time to time.

Clean your product using a mild detergent diluted in water and then polished off using a soft cloth.

If you live in a hard water area, periodically clean your product using a 50/50 solution of white vinegar and water. The solution should be left on the enclosure for approximately 5 minutes then rinsed off using warm water. This method of cleaning should remove lime scale residue.

It is strongly recommended that a quality silicone spray is used.

## A list of Donts

1. Don't use acidic based products which are unsuitable for cleaning enamel surfaces.
2. Don't use abrasive cleaners or cleaners using bleach or solvents, these products will adversely affect the finish of the aluminium profiles.
3. Don't use scouring pads, powder or any sharp instruments when cleaning the enclosure.